

Forest County

County & District Line

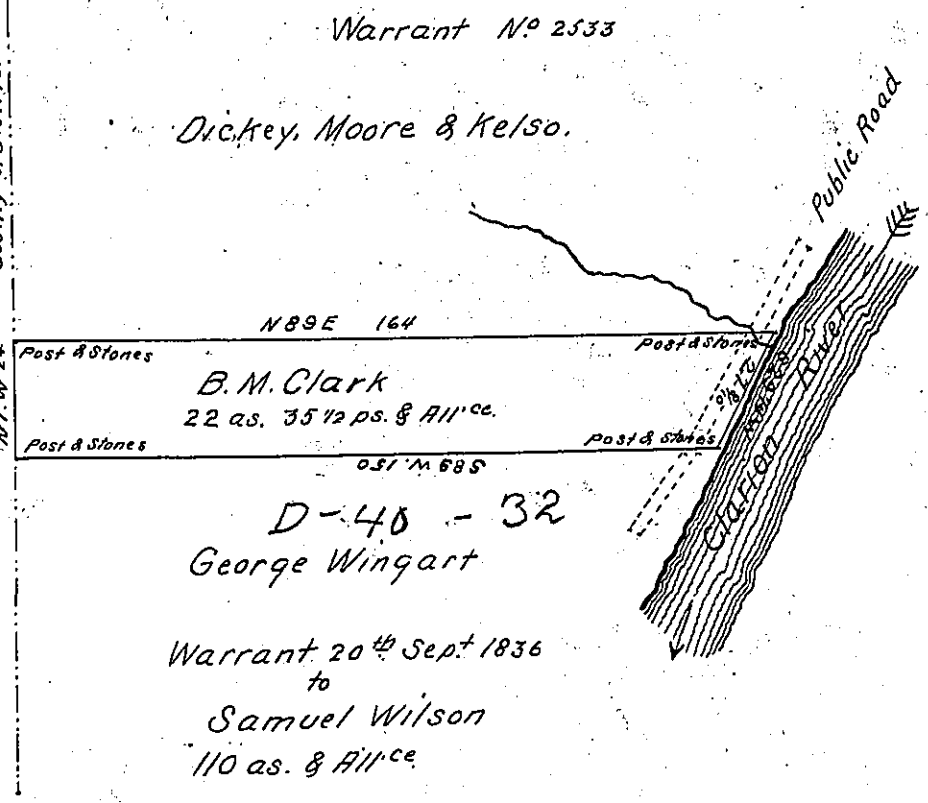

A draft of a tract of land Situated in the township of Millstone and County of Elk. Containing twenty-two acres and thirty-five and one half perches and allowance of six per cent for roads &c. Surveyed the twenty-ninth day of December 1891 in pursuance of a Warrant granted to B. M. Clark, dated the fifth day of January 1891.

E. E. Willard, C. S.

To Thos. J. Stewart, Esq.
Secretary of Internal Affairs }

IN TESTIMONY that the above is a copy of the original remaining on file in the Department of Internal Affairs of Pennsylvania, made conformably to an Act of Assembly approved the 16th day of February, 1833, I have hereunto set my Hand and caused the Seal of said Department to be affixed at Harrisburg, this SIXTH day of July 1904

Joseph P. Brown
Secretary of Internal Affairs.